

.....

PROJECT

.....

Roof terrace
Humboldt Forum
Berlin

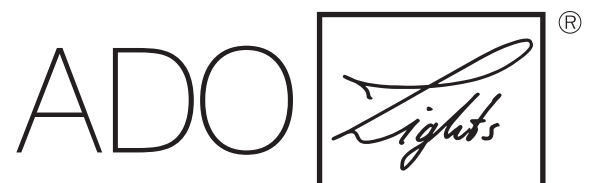

by TTC Timmler Technology



Foto: TTC-Archiv

ROOF TERRACE

Humboldt Forum
Berlin

Architect | Lighting designer

Franco Stella Architetto, I-Vicenza | Ulrike Link | Innus DÖ GmbH, Dresden

Sky over Berlin

The Berlin Palace (Berliner Schloss) once stood on Spree Island before it was severely damaged during Second World War and finally demolished in 1950.

From 2013 to 2020, a reconstruction faithful to the original exterior with a modernist interior was carried out according to plans by Italian architect Franco Stella- The secular building has since become the seat of the Humboldt Forum and houses several museums, restaurants and cafés, among other things.

On the roof terrace, around 200 metres of LED-Lightlines on the stairs around the restaurant and on the balustrades provide pleasant illumination at dusk, while allowing visitors to enjoy a panoramic view of the city. As the roof terrace has also become a popular event location, the safety aspect comes into play at later hours, as the lighting minimises the risk of falls.

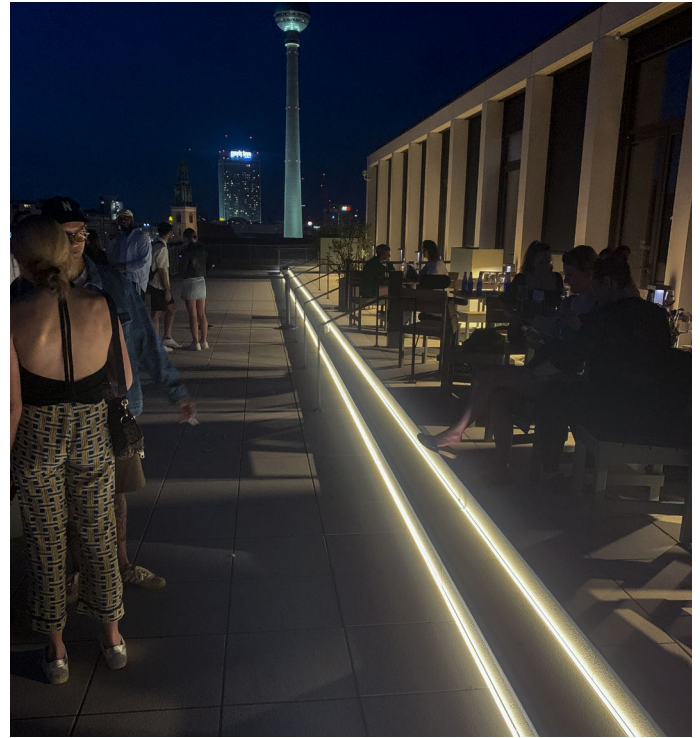

ROOF TERRACE

Humboldt Forum
Berlin

Basics

LED-Lightline | Eye-catcher + signpost

Luminous lines in the dark. Sometimes eye-catchers. Then again signposts. They accentuate entrance areas or trace architectural contours. Lines of light can be integrated into façades and floor surfaces - they are always a visual highlight.

Built-in products

- Approx. 200 m LED-Lightlines 12.30 AL, straight version, 12 x 30 mm (W x H), anodised aluminium
- Light colour 3200 K, 24 V/DC, 10 W/m, IP68, supply line IP67, opaque PU casting, homogeneous light emission
- L-50 mounting profile made of stainless steel for mounting the light line, asymmetrical base plate for use on block steps

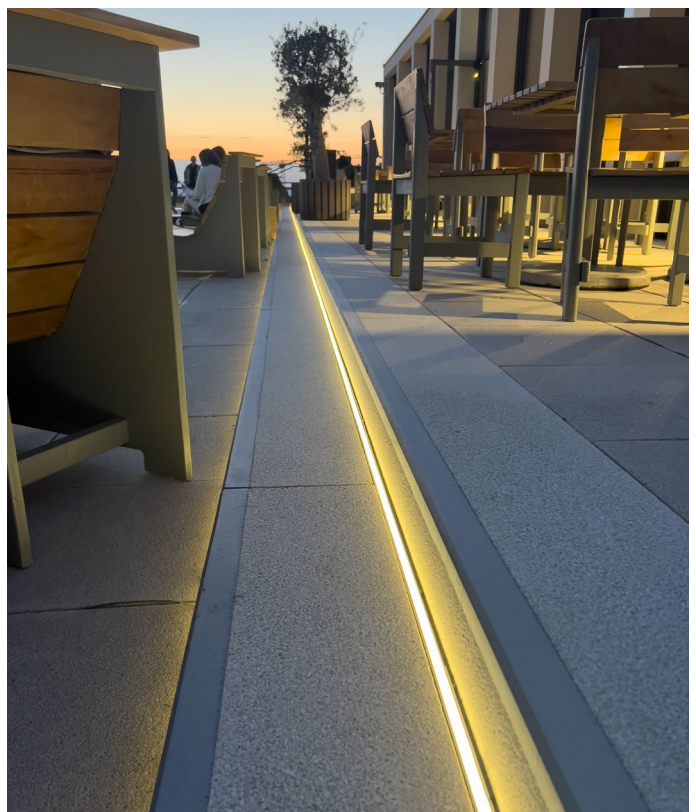
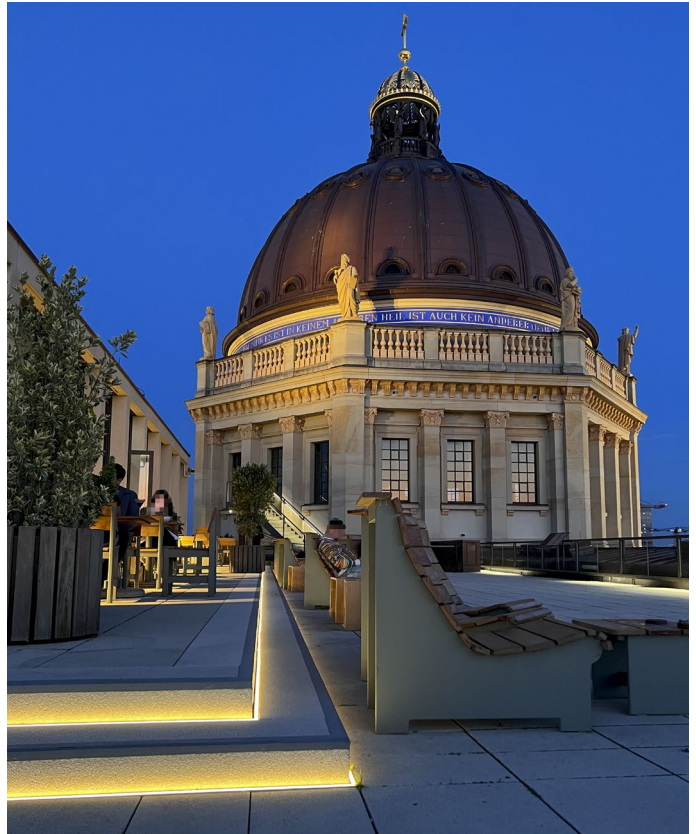

ROOF TERRACE

Humboldt Forum
Berlin



Quick info | Technical drawings



ado-lights.com/lightline

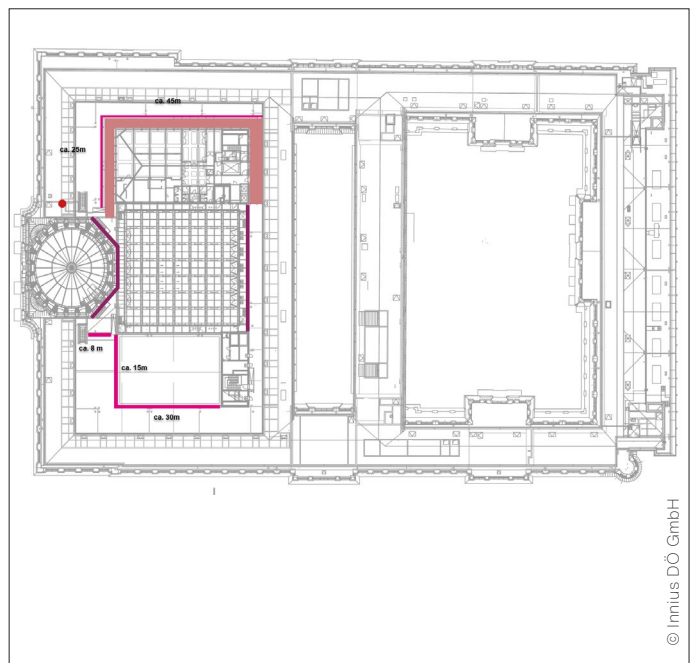
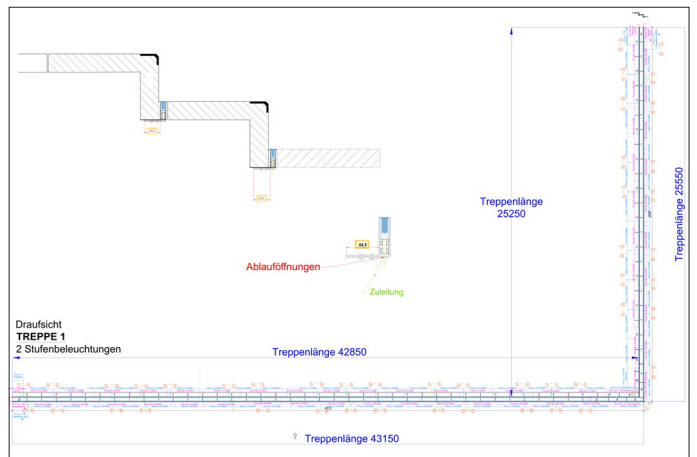

Photos: TTC archive

© Imius DÖ GmbH

TTC Timmler Technology GmbH
Christian-Schäfer-Straße 8
D-53881 Flammersheim [Cologne/Bonn]
T +49 2255 9212-00
F +49 2255 9212-99
E info@ado-lights.com
I www.ado-lights.com
www.led-luc.com



by TTC Timmler Technology

